

GLASS & WALL-SYSTEMS

GENERAL • EDITION 7

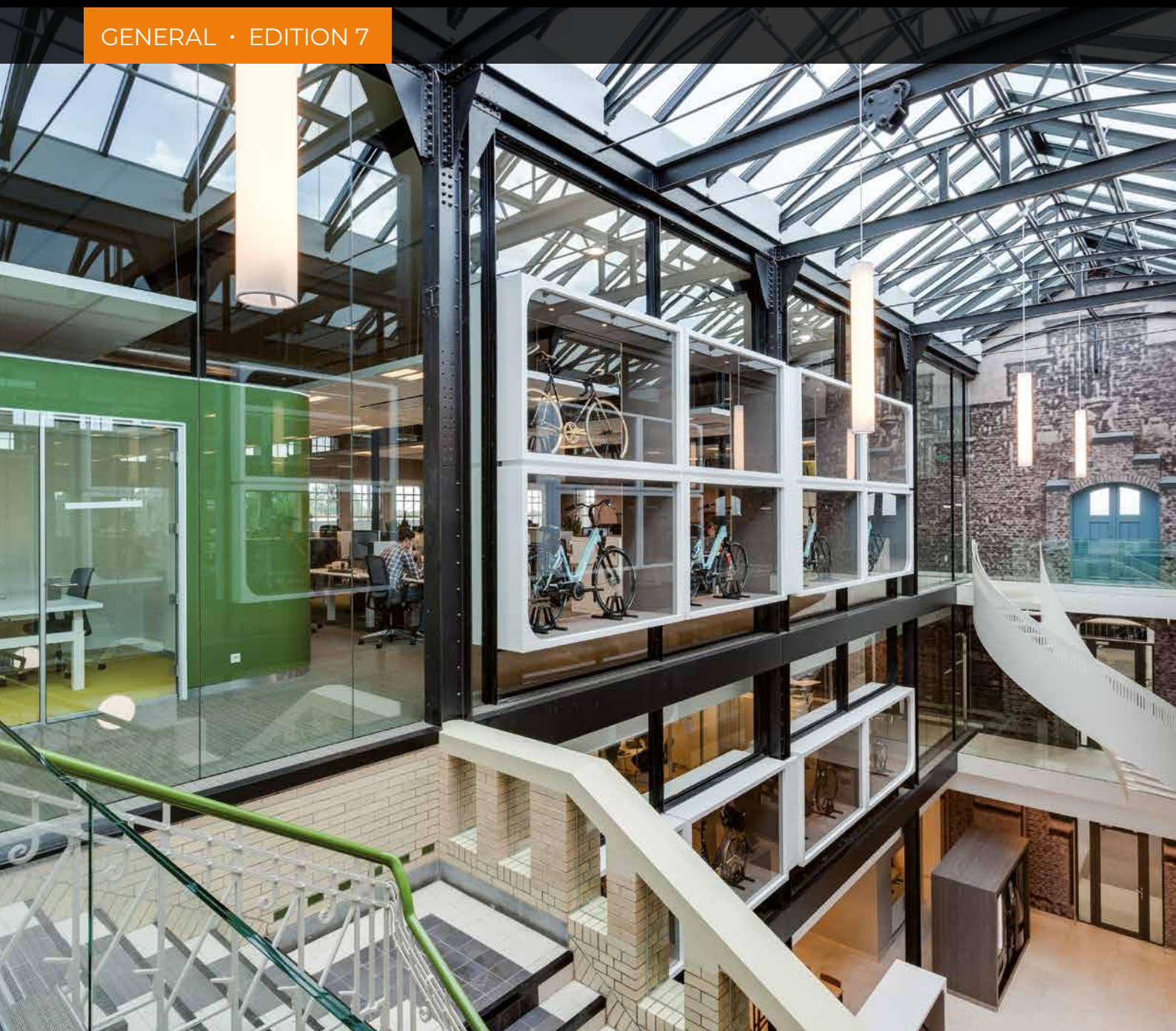

Introduction

3



Multifunctional full-glass wall-systems:
SYSTEMS STRUCTURE™
Fire resistant full-glass walls

4



SYSTEMS CLIP-IN™
No glue full-glass walls

8



SYSTEMS CLIP-IN SILENCE™
Sound insulating full-glass walls

9



SPECIALS
Types of glass and personal signature

16



PROJECT A12 Architecten - Veenendaal
PRODUCT SYSTEMS SILENCE™
ARCHITECT A12 Architecten - Veenendaal

PICTURE COVER

Project Koninklijke Gazelle Fabriek Dieren
Product SYSTEMS CLIP-IN SILENCE
ARCHITECT BRONSVOORT BLAAK
ARCHITECTEN BNA Amerongen

The application of glass in interior design gains popularity. This is hardly surprising, for glass is a very versatile material which, according to your wishes, can be very present or hidden without any shortfall to its functionality. Offices with glass dividing-walls offer a certain privacy but look more spacious. This because the (natural) light spreads through the spaces. Glass dividing-walls can also help accentuate the identity, the uniqueness and the culture of a company.

The use of functional glass in interior design requires knowledge of the characteristics of glass and know-how about fitting- and connecting systems. Interior GLASSOLUTIONS has both these qualities. For your reference project Interior GLASSOLUTIONS offers technical and creative advice and product- and system development, manufactured and placed in a perfect combination of functionality and design.

Tested multi-functional glass

Focal points of Interior GLASSOLUTIONS are complete glass solutions which are fire resistant, sound insulating and use no glues. These SYSTEMS™ are produced with tested safety glazing and are in accordance with the European safety-rules and the Dutch NEN6702 and NEN3569 guidelines. New in our fire resistant range are our glass doors!

Besides the safety, the privacy-comfort does not have to be limited by the use of glass dividing-walls. SYSTEMS SILENCE™ offers a high grade of sound insulation for a wall, including a door. Whatever function or combination of functions you choose, glass is pre-eminently suited for aesthetic uses: fully transparent, translucent or of your own design. With this glassinfo we hope to positively contribute to your own inspiration and creativity.

For more projects or additional information, please visit our website at www.interiorglassolutions.nl



PROJECT De Doelen - Rotterdam
PRODUCT ssa SATINOVO MATÉ®
ARCHITECT Soap Ateliers - Rotterdam



PROJECT UPC - Schiphol
PRODUCT SPECIALS
ARCHITECT Storage - Amsterdam



SYSTEMS STRUCTURE™ allows for the creation of more transparency within the legal guidelines, despite the limitations stipulated by the Building regulations concerning fire resistance.

Walls

The system SYSTEMS STRUCTURE™ consists of fire resistant glass panels which are linked together with a special glue-joint. The basic glazing consists of a number of glass panels which are compounded into layered glass. Then a number of these layers are inseparably linked by one or more transparent, colourless interlayers which will foam up in case of fire. In case of fire, these glass panels form an opaque and stable separation which is fire resistant and reduces radiation.

SYSTEMS STRUCTURE™ glass panels are finished on all sides with a specific rim-seal. This prevents reactions between the interlayer and the surrounding area. This results in a high quality fire resistant glazing which can be linked together into a glass construction of infinite length.

The total concept SYSTEMS STRUCTURE™ offers protection against fire disruption on both sides for 30 or 60 minutes. With this, the fire resistance glazing is in accordance with both the Building regulations and the European norms of the EW-class or even the EI-class.

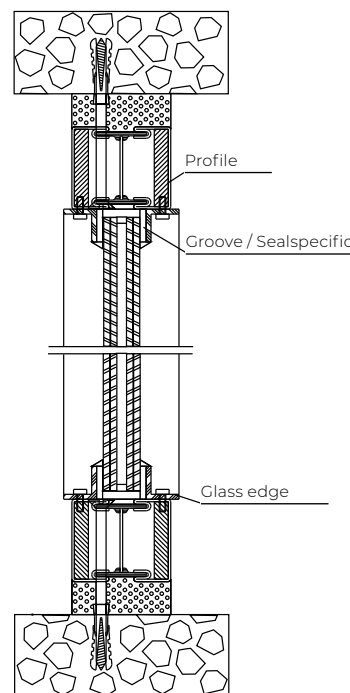



PROJECT Woonzorg - Amstelveen
PRODUCT SYSTEMS STRUCTURE ANGLE™
ARCHITECT Koen van Velsen - Hilversum

PROJECT ANWB - Wassenaar
PRODUCT SYSTEMS FIRE DOOR E30™
ARCHITECT Liag - Den Haag

Corner constructions

It is possible in a full-glass fire resistant wall to create a full-glass corner with the use of SYSTEMS STRUCTURE™. The SYSTEMS STRUCTURE ANGLE™ can be placed at a 45° or 90° degree angle and has been tested in both the EW-class as the EI-class.

Doors

The SYSTEMS FIRE DOOR™ combines the transparency of SYSTEMS STRUCTURE™ with the looks of a glass door while retaining the functional requirements of a fire resistant door. This pivoting glass door meets the demand to create more transparency in buildings.

Combinations and availability

SYSTEMS STRUCTURE™ can be combined with all approved wooden, steel or aluminium frames and is well-suited for use in, amongst other, office-buildings and shopping malls.

The look of SYSTEMS STRUCTURE™ can be personalized by choosing aesthetic kinds of glass; lacquered, etched, enamelled, with coloured foil or figured glass.

• Tested dimensions			
	EW/EI	max. width (mm)	max. height (mm)
SYSTEMS STRUCTURE™	30	1800	3500
SYSTEMS STRUCTURE™	60	1500	3500

SYSTEMS STRUCTURE EW30/60™
SYSTEMS STRUCTURE EI30™
SYSTEMS FIRE DOOR CP1 30/60™

• Maximum dimensions

Wall	SYSTEMS STRUCTURE EW30™	1680 x 3600 mm
	SYSTEMS STRUCTURE EI30™	1800 x 3500 mm
	SYSTEMS STRUCTURE EW60™	1650 x 3000 mm
	SYSTEMS STRUCTURE EI60™	1500 x 3450 mm
Door	SYSTEMS FIRE DOOR CP1 30™	1380 x 2568 mm
	SYSTEMS FIRE DOOR CP1 60™	1380 x 2568 mm



SYSTEMS STRUCTURE EW30/60™
SYSTEMS STRUCTURE EI30™/60™
SYSTEMS FIRE DOOR ECON 30/60™

• Maximum dimensions

Wall	SYSTEMS STRUCTURE EW30™	1680 x 3600 mm
	SYSTEMS STRUCTURE EI30™	1800 x 3500 mm
	SYSTEMS STRUCTURE EW60™	1650 x 3000 mm
	SYSTEMS STRUCTURE EI60™	1500 x 3450 mm
Door	SYSTEMS FIRE DOOR ECON 30™	1400 x 3390 mm
	SYSTEMS FIRE DOOR ECON 60™	1400 x 3390 mm



SYSTEMS STRUCTURE EI30™
SYSTEMS STRUCTURE CORNER EI30™/60™
SYSTEMS FIRE DOOR LUNAX EW30/60™

• Maximum dimensions

Wall	SYSTEMS STRUCTURE EW30™	1680 x 3600 mm
	SYSTEMS STRUCTURE EI30™	1800 x 3500 mm
	SYSTEMS STRUCTURE EW60™	1650 x 3000 mm
	SYSTEMS STRUCTURE EI60™	1500 x 3450 mm
	SYSTEMS STRUCTURE CORNER™ EI30™	1800 x 3500 mm
	SYSTEMS STRUCTURE CORNER™ EI60™	1500 x 3438 mm
Door	SYSTEMS FIRE DOOR LUNAX EW30™	1000 x 2650 mm
	SYSTEMS FIRE DOOR LUNAX EW60™	1000 x 2650 mm
	SYSTEMS FIRE DOOR LUNAX DUBBEL EW30™	2000 x 2650 mm
	SYSTEMS FIRE DOOR LUNAX DUBBEL EW60™	2000 x 2650 mm



SYSTEMS STRUCTURE ISO 30™/60™

• Maximum dimensions

Wall	SYSTEMS STRUCTURE ISO 30™	1800 x 3500 mm
Wall	SYSTEMS STRUCTURE ISO 60™	1250 x 3000 mm



ASSEMBLY
INCLUDED



PROJECT Wieden Kennedy
PRODUCT SYSTEMS STRUCTURE 30™ en
SYSTEMS STRUCTURE 60™
ARCHITECT Next architects - Amsterdam

Picture: Iwan Baan



You want optimum effect of the transparency of the glass combined with a high level of flexibility? SYSTEMS CLIP-IN™ makes that traditional and visible glue-seams are no longer necessary. What's more; with SYSTEMS CLIP-IN™ it is simpler to alter the compartments of the room.

Walls

SYSTEMS CLIP-IN™ is a systems which does not require glue for the vertical seams. In the SYSTEMS CLIP-IN™ range, a specially developed machine cuts a groove in the vertical sides of the glass panels. With a slender and transparent coupling strip the panels can easily be 'clipped' together. Coupling to an architectural construction can be done without the use of glue, by using the optional CLICK25™ strip. 4 SYSTEMS SILENCE™ walls were also tested as sound insulating system.

Doors

Various types of no-glue doors are also available in the SYSTEMS CLIP-IN™ range. A hinging door in a no-glue frame and a pivoting door in a no-glue frame. Both were also tested by the OASR as sound insulating system.

Glass coupling profiles

CLIP-IN X-profile™

CLIP X10-12
(also available CLIP X17)

CLIP-IN T-profile™

CLIP T10-12
(also available CLIP T17)

CLIP-IN corner profile™

CLIP H10-12
(also available CLIP H17)

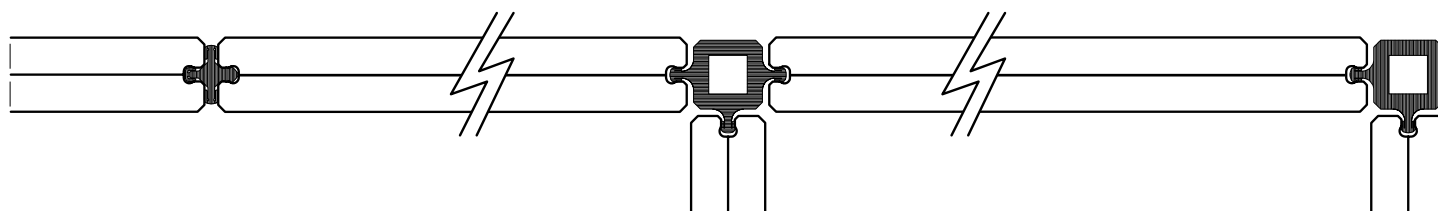

Architectural couplings

CLICK25-10™

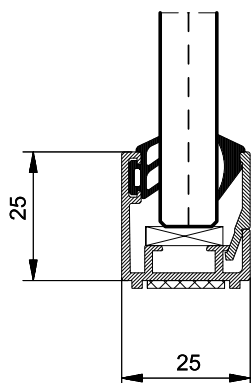

t.b.v. 55.2 glass

CLICK25-12™

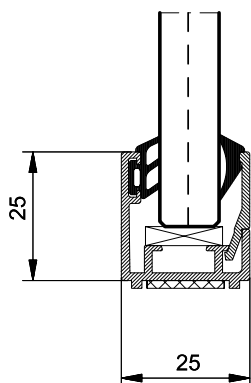

t.b.v. 66.2 glass

CLICK25-17™

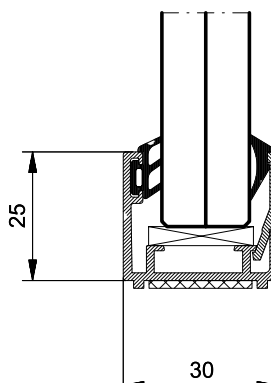

t.b.v. 88.2 glass

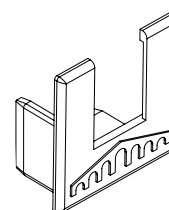

CLICK25™ end-cap



Do you wish to enjoy the transparency of glass in peace and quiet, using an extremely flexible system? SYSTEMS CLIP-IN SILENCE™ combines all of these desirable features.

Walls

The SYSTEMS CLIP-IN SILENCE™ uses SGG STADIP SILENCE®, which is glass layered using an acoustic foil PVB (A). The acoustic foil has no effect whatsoever on the translucence of the glass. The layered glass also prevents people from walking or falling through the glass wall. The walls have been tested up to a noise reduction level of 60dB.

Doors

SYSTEMS SILENCE DOOR™ is the collective name for these soundproof door systems, which can be used without creating noise leaks in the soundproof walls. This product range includes both hinging and pivoting doors. The doors have been tested by TNO and Peutz up to RW values up to 47dB

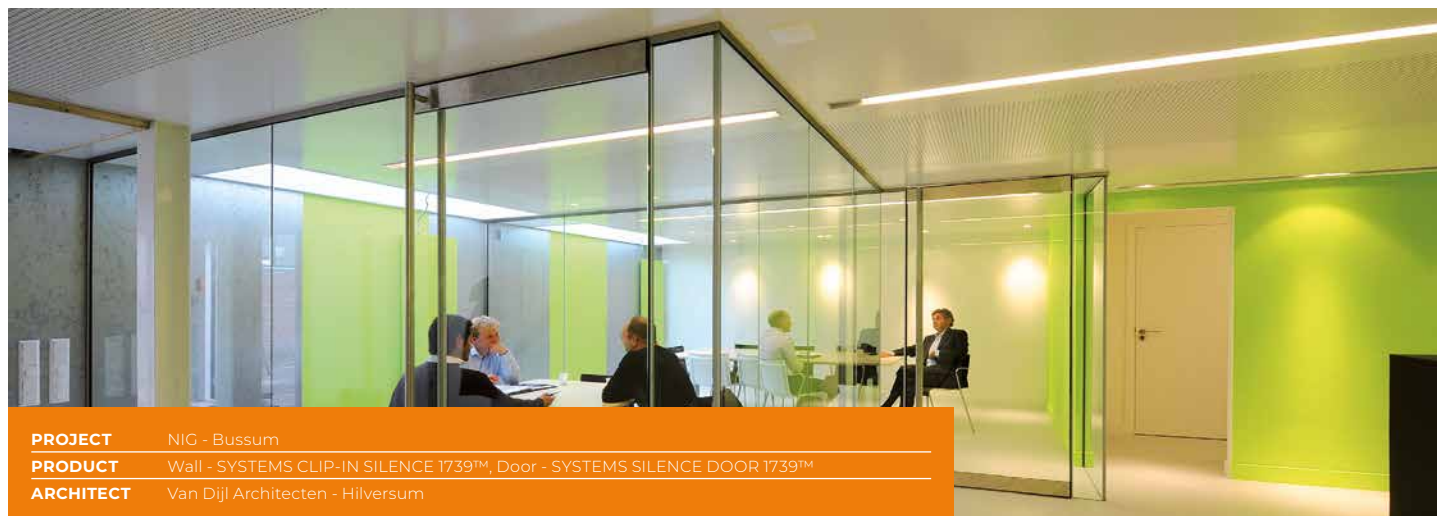

PROJECT NIC - Bussum
PRODUCT Wall - SYSTEMS CLIP-IN SILENCE 1739™, Door - SYSTEMS SILENCE DOOR 1739™
ARCHITECT Van Dijk Architecten - Hilversum



PROJECT De Hoep - Castricum
PRODUCT SYSTEMS SILENCE™
ARCHITECT Min2 - Bergen aan Zee



PROJECT NOKIA Silence Booth
PRODUCT SYSTEMS SILENCE™
ARCHITECT SGG-IGS - Amersfoort

SYSTEMS SILENCE DOOR PC1032™ / PC1135™ / PC1337™

• Sound-proofing values

Wall single	SYSTEMS CLIP-IN SILENCE 1132™	$R_w = 32\text{dB}$	Peutz rapport: 2283-5-RA
Wall single	SYSTEMS CLIP-IN SILENCE 1136™	$R_w = 36\text{dB}$	TNO rapport: MON-RPT-2008-01826
Wall single	SYSTEMS CLIP-IN SILENCE 1338™	$R_w = 38\text{dB}$	TNO rapport: MON-RPT-2008-01824
Door	SYSTEMS SILENCE DOOR PC1032™	$R_w = 32\text{dB}$	TNO rapport: MON-RPT-2010-01980
Door	SYSTEMS SILENCE DOOR PC1135™	$R_w = 35\text{dB}$	TNO rapport: MON-RPT-2010-01981
Door	SYSTEMS SILENCE DOOR PC1337™	$R_w = 37\text{dB}$	TNO rapport: MON-RPT-2010-01982



SYSTEMS CLIP-IN SILENCE DOOR 1337-01™ / 1337-02™

• Sound-proofing values

Wall single	SYSTEMS CLIP-IN SILENCE 1338™	$R_w = 38\text{dB}$	TNO rapport: MON-RPT-2008-01824
Door	SYSTEMS CLIP-IN SILENCE DOOR 1337™	$R_w = 37\text{dB}$	TNO rapport: MON-RPT-2008-01823



SYSTEMS SILENCE DOOR 1338™ / 1739™

• Sound-proofing values

Wall single	SYSTEMS CLIP-IN SILENCE 1338™	$R_w = 38\text{dB}$	TNO rapport: MON-RPT-2008-01824
Door	SYSTEMS SILENCE DOOR 1338™	$R_w = 38\text{dB}$	TNO rapport: IS-RPT-060038
Wall single	SYSTEMS CLIP-IN SILENCE 1739™	$R_w = 39\text{dB}$	TNO rapport: MON-RPT-2008-01823
Door	SYSTEMS SILENCE DOOR 1739™	$R_w = 39\text{dB}$	TNO rapport: IS-RPT-060040



SYSTEMS SILENCE DOOR PC4200™ / PC4700™

• Sound-proofing values

Wall single	SYSTEMS CLIP-IN SILENCE 2242™	$R_w = 42\text{dB}$	Peutz rapport: A 3114-31-RA
Wall double	SYSTEMS CLIP-IN SILENCE 6600/42™	$R_w = 42\text{dB}$	Peutz rapport: A 2283-13-RA
Wall double	SYSTEMS CLIP-IN SILENCE 6500/45™	$R_w = 45\text{dB}$	Peutz rapport: A 2283-2-RA
Wall double	SYSTEMS CLIP-IN SILENCE 6600/48™	$R_w = 48\text{dB}$	Peutz rapport: A 2283-14-RA
Wall single	SYSTEMS CLIP-IN SILENCE 6950™	$R_w = 50\text{dB}$	Peutz rapport: A 3114-106-RA
Wall double	SYSTEMS CLIP-IN SILENCE 6600/56™	$R_w = 56\text{dB}$	Peutz rapport: A 3114-160-RA
Wall double	SYSTEMS CLIP-IN SILENCE 6625/60™	$R_w = 60\text{dB}$	Peutz rapport: A 3114-139-RA
Door	SYSTEMS SILENCE DOOR PC4200 + T-greep	$R_w = 42\text{dB}$	Peutz rapport: A 2394-2-RA
Door	SYSTEMS SILENCE DOOR PC4700 + T-greep	$R_w = 47\text{dB}$	Peutz rapport: A 2394-2-RA



SYSTEMS SILENCE SLIDING DOOR 1736™

• Waarden geluidwering

Wall single	SYSTEMS CLIP-IN SILENCE 1739™	$R_w = 39\text{dB}$	TNO rapport: MON-RPT-2008-01823
Door	SYSTEMS SILENCE SLIDING DOOR 1736™	$R_w = 36\text{dB}$	Peutz rapport: A 2054-1-RA 16 juli 2010





PROJECT De Brauw Blackstone Westbroek - Amsterdam
PRODUCT Wall - SYSTEMS CLIP-IN SILENCE 1338™ + SGG SERALIT®, Door - SYSTEMS CLIP-IN SILENCE DOOR 1337-01™ + SGG SERALIT®
ARCHITECT Erick van Egeraat - Rotterdam



PROJECT CIRQADA - Utrecht
PRODUCT Wall - SYSTEMS CLIP-IN SILENCE 1338™, Door - SYSTEMS CLIP-IN SILENCE DOOR 1337™
ARCHITECT Jeanne Dekkers Architectuur - Delft

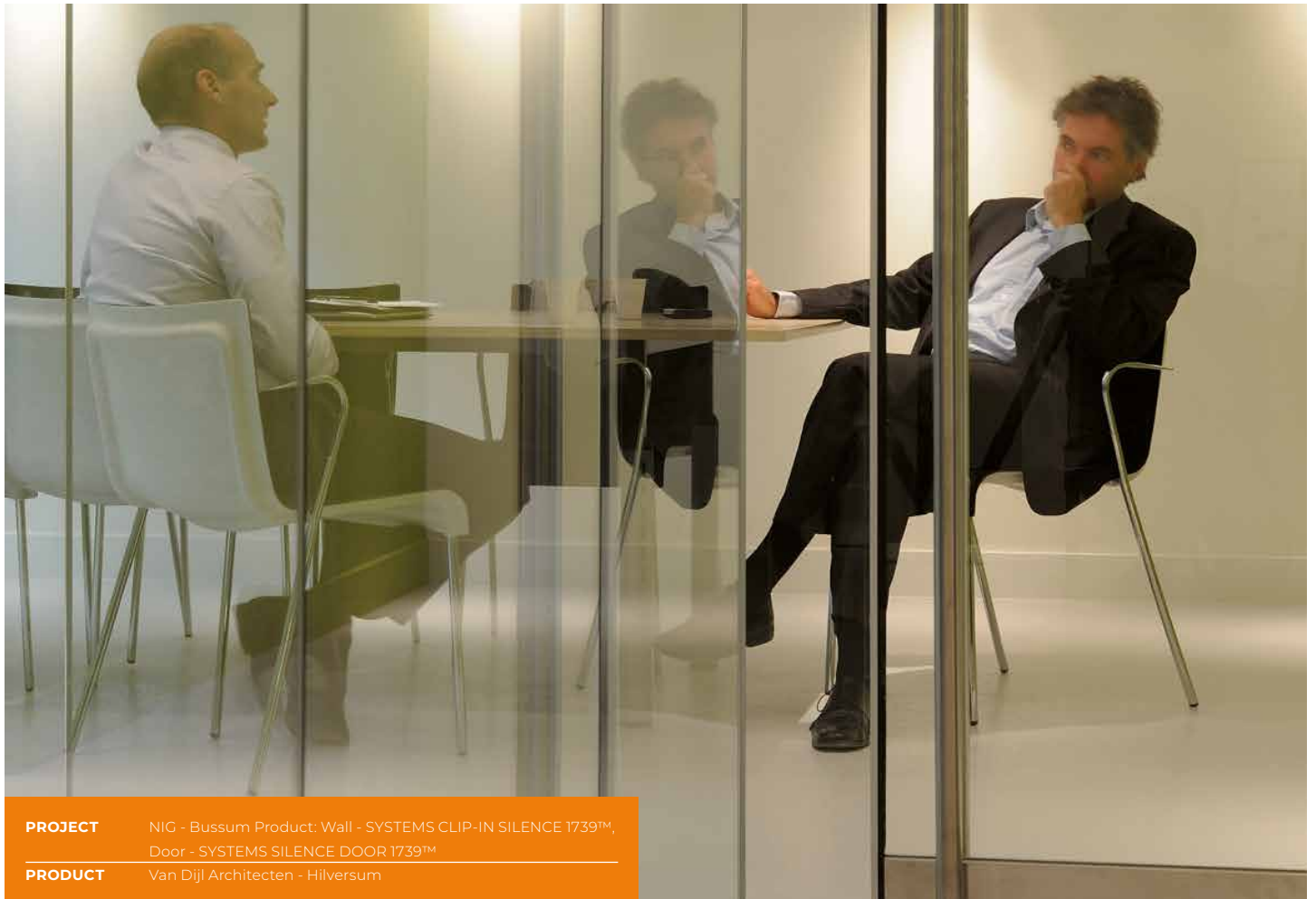



PROJECT MCE Tennet - Arnhem
PRODUCT Wall - SYSTEMS CLIP-IN SILENCE 1338™ + CURVED, Door - SYSTEMS SILENCE DOOR PC1337™
ARCHITECT Studio Groen+Schild - Deventer



PROJECT SABIC - EuroPetrochemicals B.V. - Sittard
PRODUCT Wall - SYSTEMS SILENCE 1740™ en 1338™, Door - SYSTEMS SILENCE DOOR 1739™ en 1338™
ARCHITECT Group A Architects - Rotterdam





PROJECT Wilhelminasingel - Maastricht
PRODUCT 15 mm gehard glas, SGG SECURIPOINT met SGG SERALIT EVOLUTION zeefdruk
ARCHITECT A3K Architecten Maastricht



PROJECT Pathé Amsterdam
PRODUCT sgg STADIP SERALIT
ARCHITECT Architecten Cie Amsterdam

Picture: Marc Detiffe



The types of glass that can be used are bound by personal preferences and actual fashion trends. The only limitation for the use, is that the glass has to be in accordance with the specifications of NEN 3569 ("Safety-glazing within buildings") and NEN 6702 ("Architectural safety") In order to realise a safe use of the glass it is important that the type of glass chosen for a particular project can be hardened or layered. The following table presents a summary of the various types of glass and their level of transparency.

Type of glass	Possibilities
transparent glass	scc SECURIT® white hardened glass
	scc STADIP® white layered glass
	scc SECURIT®/STADIP® with coloured or extra clear scc DIAMANT® glass
	scc STADIP COLOR® layered glass with coloured transparent foil
	scc PARSOL® coloured glass
	scc LITE-FLOOR®
	scc CONTRAFLAM®
	scc STADIP SILENCE®
translucent glass	scc SATINOVO MATÉ® etched glass
	scc SERALIT EVOLUTION® ardened and decorative screen printed glass
opaque glass	scc EMALIT EVOLUTION® enamelled glass (dark background required)
specials	scc CRAQUELÉ® layered glass with 'crush' effect
	sandblasted or etched glass with own motive
	scc CONTOUR® bent layered glass
	scc IMAGE® layered glass with printed foil and tailor-cut image
	scc PRIVA-LITE® glass with controllable transparency
	scc CREA-LITE RELIEF® glass-creations of thermally shaped glass
	scc CREA-LITE COLOR® glass-creations with thermally shaped glass and added color



PROJECT Triodosbank - Zeist
PRODUCT scc PRIVA LITE®
ARCHITECT Rau & Partners - Amsterdam





PROJECT ATLAS - Amsterdam
PRODUCT sgg EMALIT EVOLUTION®
ARCHITECT Axel Grothausen - Bussum

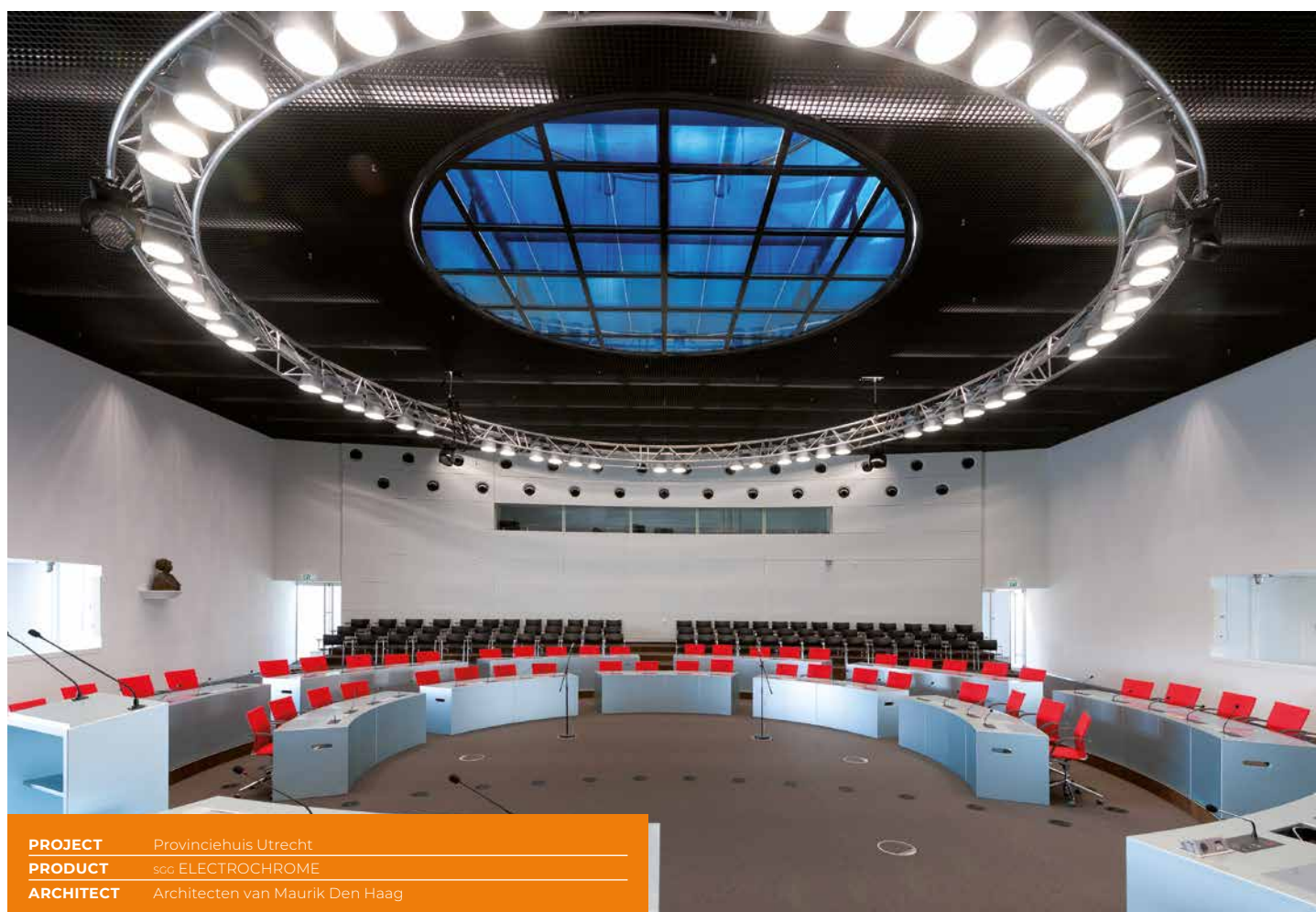

PROJECT Provinciehuis Utrecht
PRODUCT sgg ELECTROCHROME
ARCHITECT Architecten van Maurik Den Haag

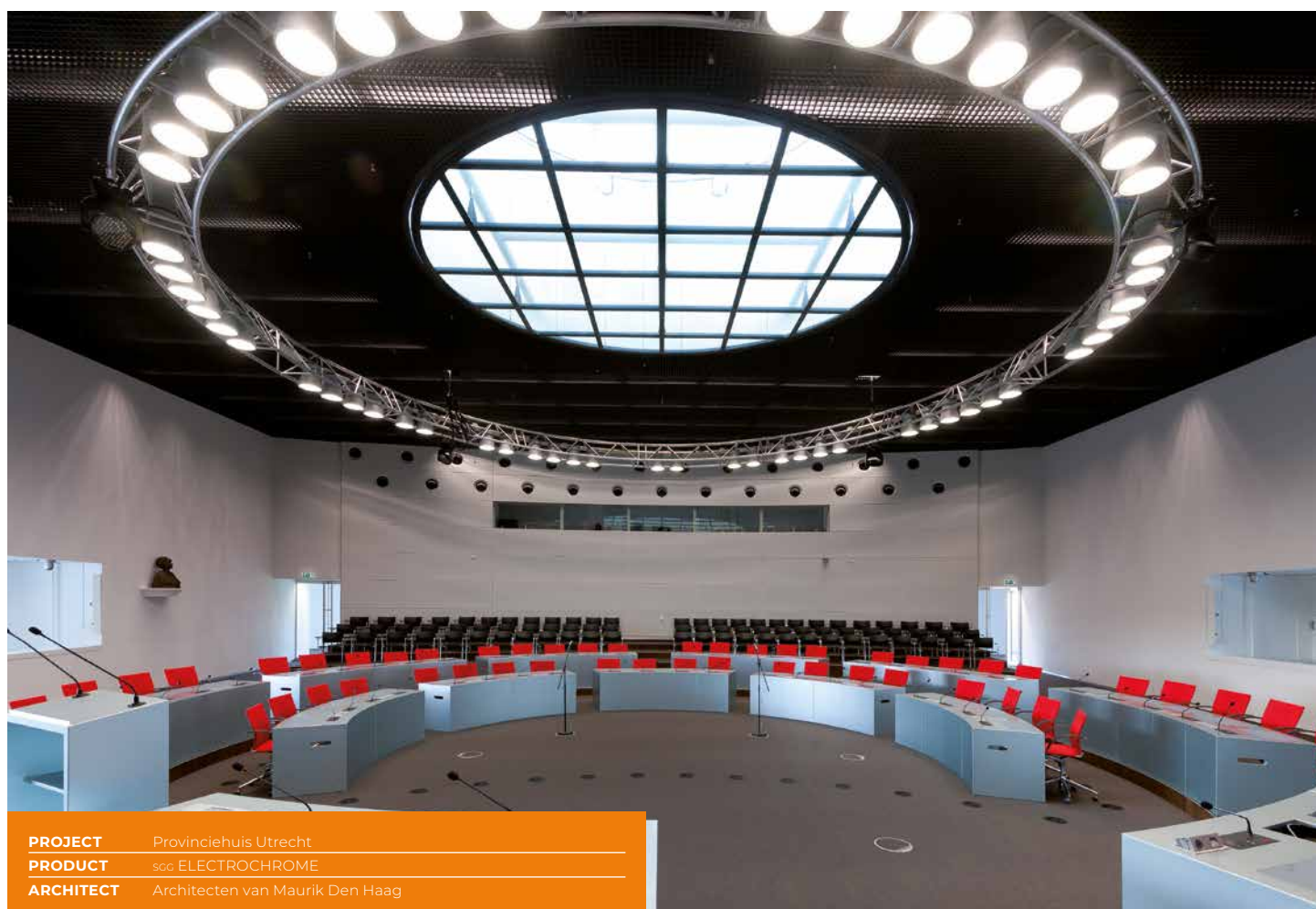



PROJECT Entree Paleis Het Loo - Apeldoorn
PRODUCT SYSTEMS SPECIAL HET LOO
ARCHITECT Architectenbureau Koen van Velsen



PROJECT Nijestee - Groningen
PRODUCT scc STADIP FIRE FLOOR + PUB Print
ARCHITECT ONIX



PROJECT Nijestee - Groningen
PRODUCT scc STADIP FIRE FLOOR + PUB Print
ARCHITECT ONIX



PROJECT Sanadome - Nijmegen
PRODUCT SYSTEMS FIRE DOOR LUNAX 30
ARCHITECT Sanadome



PROJECT Klooster - Tilburg
PRODUCT UV verlijmd kap

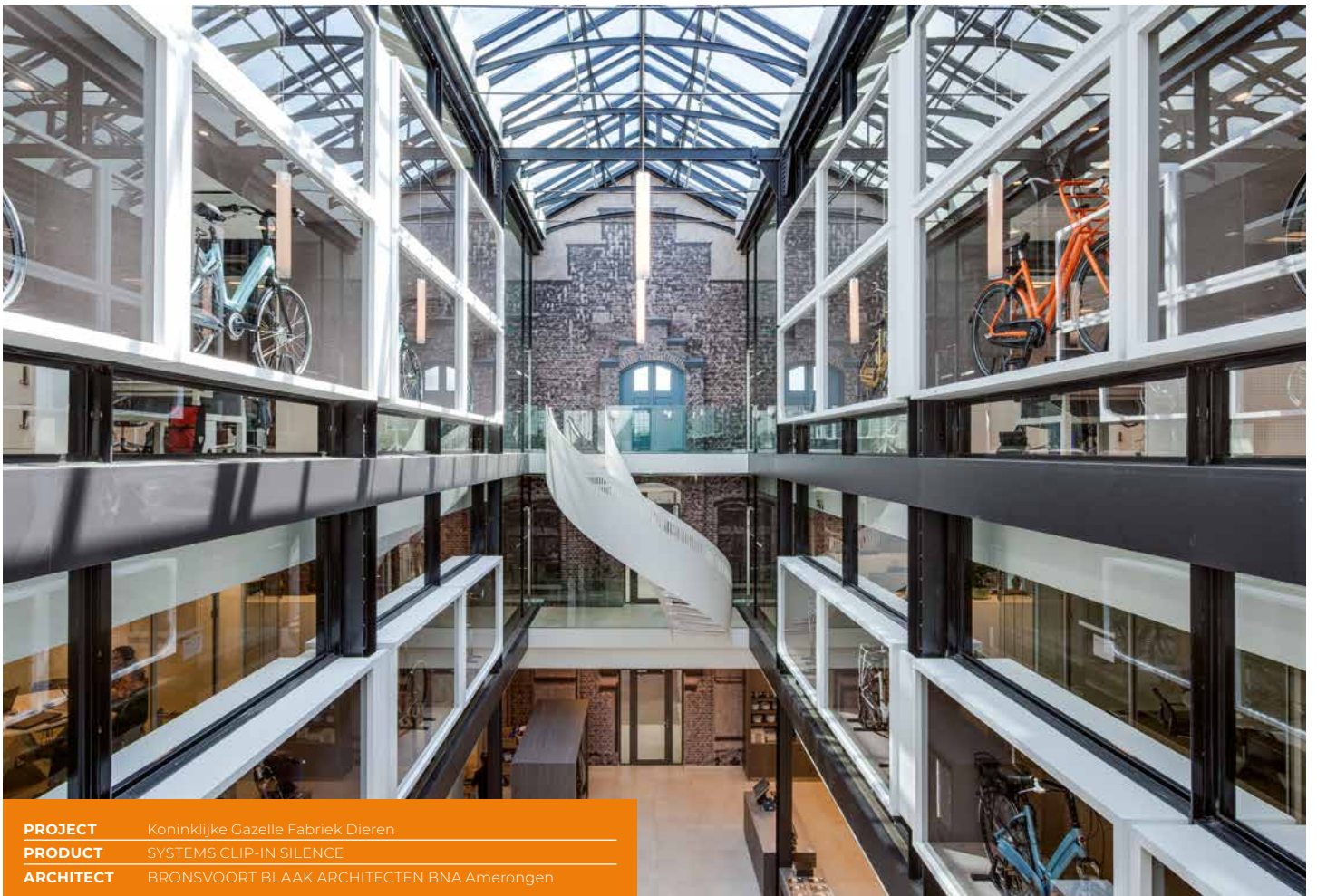

PROJECT Koninklijke Gazelle Fabriek Dieren
PRODUCT SYSTEMS CLIP-IN SILENCE
ARCHITECT BRONSVOORT BLAAK ARCHITECTEN BNA Amerongen

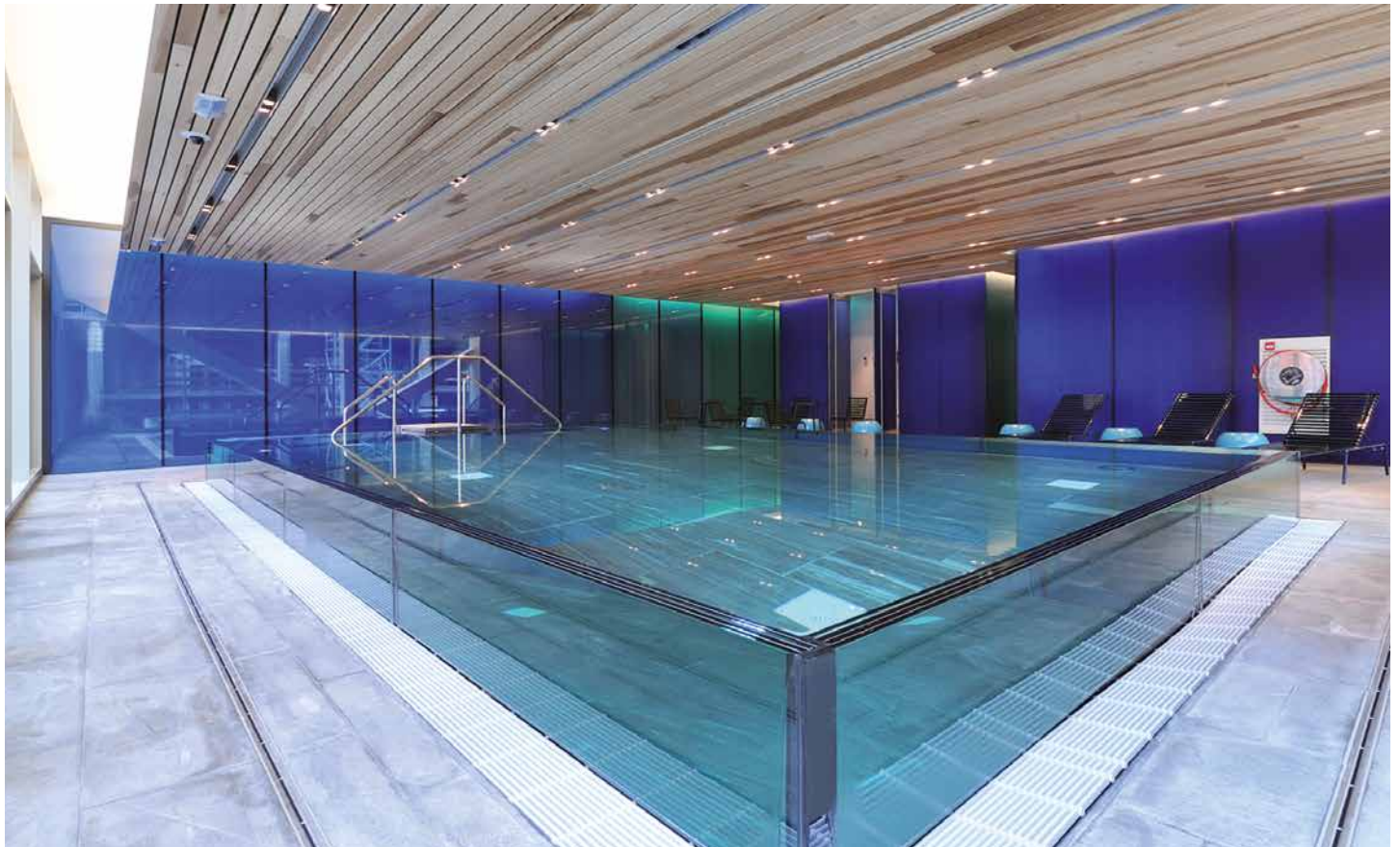

PROJECT Mahler 4 New Amsterdam - Amsterdam Product: Wall - SYSTEMS SILENCE 1739™ + sgg SERALIT® + sgg DECORGLASS®
Door - SYSTEMS SILENCE DOOR 1739™ + sgg SERALIT® + sgg DECORGLASS®

ARCHITECT de Architekten Cie - Amsterdam



PROJECT Nederlands Instituut voor Beeld en Geluid - Hilversum

PRODUCT sgg CREA-LITE®

ARCHITECT Neutelings Riedijk Architects - Rotterdam · Gevelontwerp: Jaap Drupsteen - Huizen



PROJECT NIOO - Wageningen
PRODUCT Wall - SYSTEMS SILENCE 1338™, Door - SYSTEM CLIP-IN SILENCE DOOR 1337™
ARCHITECT Claus & Kaan



PROJECT Symphony Amsterdam
PRODUCT SYSTEMS WALL CLADDING + LED

Interior Glassolutions, a division of GLASSOLUTIONS Netherlands, specialises in glass systems for interior use. In addition to supplying unputtied and noise-resistant SYSTEMS CLIP-IN™ partitioning walls, Interior GLASSOLUTIONS is always willing to contribute its know-how about glazing with specific requirements for fire resistance, noise resistance and security.



ASSEMBLY INCLUDED

Our world is our shared responsibility and everyone must contribute to the environmental conservation. Both individuals and businesses. Saint-Gobain therefore continually develops energy efficient products, which not only combine comfort and energy savings, but are also produced with respect for the environment.



In three steps we give something back to the environment: in determining our **ecological footprint**, improve it and to devise **eco innovations** for all our (new) products and services throughout their lifecycle.

Saint-Gobain Glass and GLASSOLUTIONS are the first glass manufacturers to have subjected its products to a full **Life Cycle Assessment (LCA)** and there is a very strict environmental strategy control. During the entire lifetime, including the use, these LCA's determine the environmental impact of the glazing produced by Saint-Gobain Glass and transformed by GLASSOLUTIONS.

Our LCA's are conducted in accordance with international standards ISO14040 and ISO14044 and examine two important aspects:

- All phases of the life cycle: from extraction through production, use until the end of durability;
- All environmental effects generated by the product: CO2 emissions, energy use, water use, air pollution etc.

The LCA is verified by an Environmental Product Declaration (EPD), ensuring the quality and reliability of all calculations.

Visit epd.saint-gobain-glass.com for more information on EPDs.

Interior Glassolutions specialises in glass systems for interior use. In addition to supplying unputtied and noise-resistant SYSTEMS CLIP-IN™ partitioning walls, Interior GLASSOLUTIONS is always willing to contribute its know-how about glazing with specific requirements for fire resistance, noise resistance and security.



SYSTEMS STRUCTURE™
fully-glazed fireproof walls and doors



SYSTEMS SILENCE™
sound-proof walls and doors



SYSTEMS PROTECT™
burglar-resistant and bullet-proof walls and doors



SYSTEMS CLIP-IN™
unputtied walls SYSTEMS SPECIALS™



SPIDER GLASS™
glass system for maximum transparency



SYSTEMS SPECIALS™

Interior GLASSOLUTIONS BV

Wageningselaan 42 · 3903 LA Veenendaal · The Netherlands
T +31 (0)318 24 6000 · E info@sgg-igs.com · www.interiorglassolutions.com